

# CRIMP TOOLS

## Crimp Tools



### 8-Point Crimp Tool

75Ω Center Contact Pin (Handle Color)

BNC/PI11 Patch Plugs (Red/Blue)  
BNC Jack and plug (Blue)

**010-0097**  
**010-0088**

### 12-Point Crimp Tool

75Ω Center Contact Pin (Handle color)

BNC/TNC/PI11 Patch Plug  
(Green/yellow)

**010-0098**

For crimp dies not listed or for special embossing, call the factory.



CT4L (Recommended)

### Crimp Tool (Die not included, for crimp dies see below)

Frame

**CT4L** (Black w/ longer ergonomic handle)

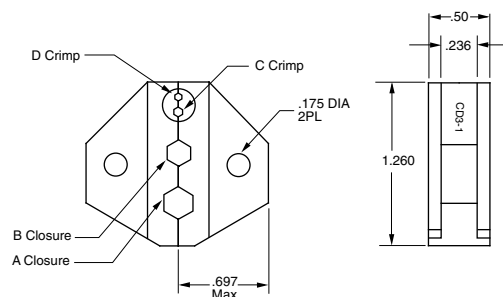

Outer Sleeve	A	Embosses	B	Embosses
<b>CD3-1</b>	.213	1A	.178	1B
<b>CD3-2</b>	.324	2A	.255	2B
<b>CD3-3</b>	.344	3A	.290	3B
<b>CD3-5</b>	-	-	.197	5B
<b>CD3-21</b>	.290	290	.255	255
<b>CD3-22</b>	.404	404	.068	-

For crimp dies not listed, call the factory.

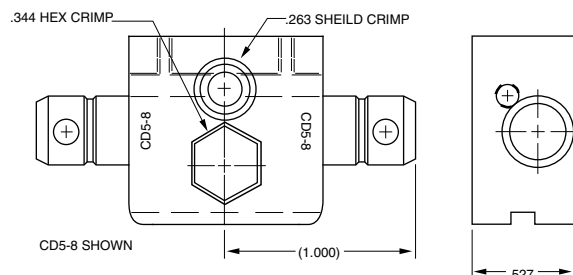

### Twinax/Triax Crimp Tool for Bushing/Shield

Crimp Tool Only **M22520/5-01**  
Crimp Tool With Die **M22520/5-01/CD5-#**

For Standard and Miniature Twinax/Triax patching: **70 Series: TRB/TRT, 150 Series: TRS/TTM, 450 Series: 2-lug/3-lug/threaded connectors.**

Connector Series	Cable Type	Cable Group#	Bushing/Shield Crimp Die	Center Contact Crimp Tool Part #	Center Contact Positioner Part #
<b>70C</b> PLR70C PLR155AC	Twinax	201-225	CD5-8	M22520/1-01	010-0044 Pin (TP837)
	Triax	301-309	CD5-10		010-0045 Socket (TP838)
Small Body 150AC	Twinax	201-206, 208, 209, 217-223	CD5-9	M22520/2-01	010-0041
	Triax	301-304, 309	CD5-11		
Large Body 150AC	Twinax	207, 210, 211-216, 224-225	CD5-8	M22520/2-01	010-0043
	Triax	305-306, 308	CD5-13		
	Triax	307	CD5-10		
PL75MC	Twinax	201-225	CD5-14	M22520/2-01	010-0096
		226	CD5-15	M22520/2-01	010-0096
450AC	Twinax	201-206, 208, 209, 212, 217-223	CD5-9	M22520/2-01	010-0041
PLR450	Twinax	201-206, 208, 209, 212, 217-223	CD5-120	M22520/2-01	010-0041
SPC8P	Twinax	201-205, 217, 218, 221, 222	CD5-4	M22520/2-01	Daniels K709
SPC8S	Triax	301-303	CD5-7		

\* Note: Dies imprint either cavity (A/B) or hex size onto crimp sleeve. Custom dies are available for special imprints.