

AUDIO PATCHING, STANDARD COAX PATCHING & LOOPING PLUGS

Standard Coax Looping Plugs

Plain Handle Shown

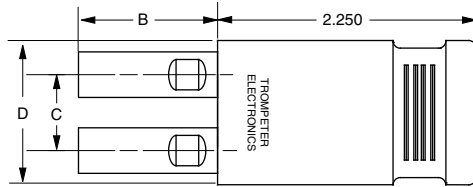

BNC Monitor



Pinch



Test Point

Looping Plugs

Handle: B=1.51" C=.625" D=1.20"

	Center Pin	50Ω RCA
Plain	.070"	LP-Z
Pinch	.070"	LPP-Z
Test Point Single	.070"	LP2TP-Z
Test Point Dual	.070"	LPA-Z
BNC Monitor	.070"	

Handle: B=1.51" C=1.00" D=1.57"

	Center Pin	50Ω RCA
Plain	.070"	LPL-Z
Test Point Single	.070"	LPLTP-Z
BNC Monitor	.070"	LPLA-Z

Handle : B=1.25" C=.625" D=1.20"

	Center Pin	75Ω WE
Plain	.090"	LPW-Z
Pinch	.090"	LPPW-Z
Test Point Single	.090"	LPWTP-Z
Test Point Dual	.090"	LPW2TP-Z
BNC Monitor	.090"	LPWA-Z

Handle: B=1.25" C=1.00" D=1.57"

	Center Pin	75Ω WE
Plain	.090"	LPLW-Z
Test Point Single	.090"	LPLWTP-Z
BNC Monitor	.090"	LPLWA-Z

Handles are color coded:
Green = 50Ω Violet = 75Ω

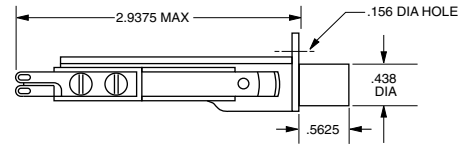

Single Audio Jack
3 Circuit Normaling
JJO-42 Type

M641/3-2

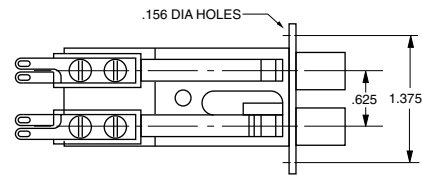

Dual Audio Jack
3 Circuit Normaling
WECO 482A Type

MT389

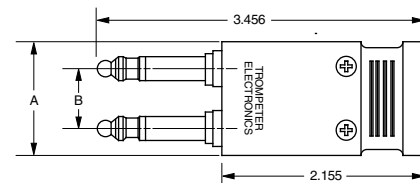

ALP3 A = 1.200 B = .625
ALPL3 A = 1.570 B = 1.000

Looping Plug
Audio (Hair Pin)
Plain

ALP3/ALPL3

Z = denotes impedance of connecting cable in ohms. Audio Patch Cords also available, please call factory.