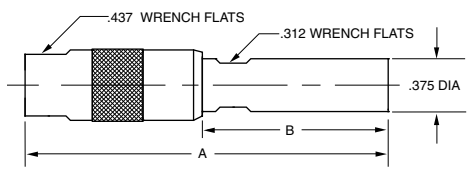
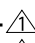
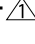
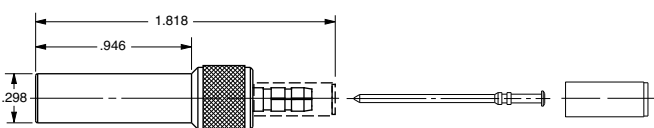
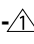
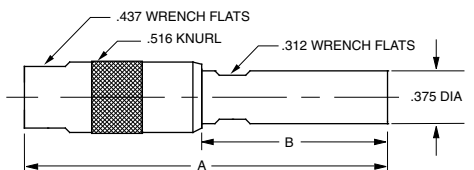
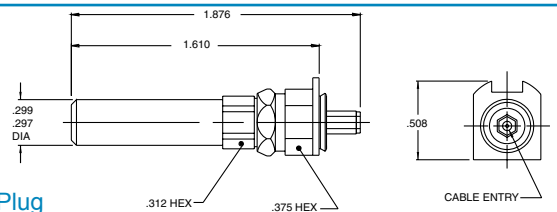
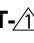
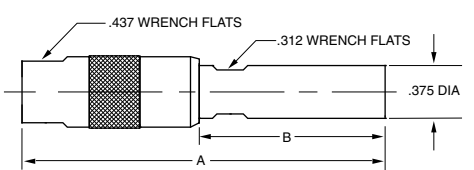
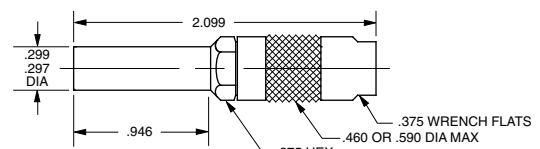
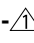
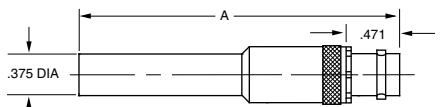
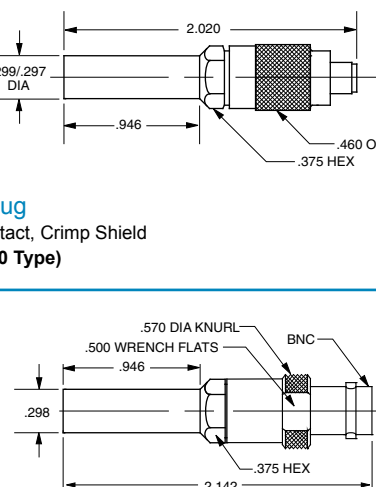
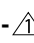
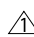

STANDARD & MINI-WECO Coax Patch Plugs

 <p>Patch Plug Shield Crimp</p> <p>50Ω RCA Center pin .070" A=2.73" B=1.50" PL1C-  75Ω WE Center pin .090" A=2.45" B=1.22" PL1WC- </p> <p>(WECO 358 type)</p>	 <p>Patch Plug Standard BNC Strip dimension Crimp Contact, Crimp Shield</p> <p>(WECO 440 Type) PL11SC- </p>
 <p>Patch Plug Cable Entry, Field Serviceable</p> <p>For RG58 50Ω RCA Center pin .070" A=2.80" B=1.568"..... PL1 For RG59 50Ω RCA Center pin .070" A=2.737" B=1.505"..... PL2 For RG58 75Ω WE Center pin .090" A=2.52" B=1.288"..... PL1W For RG59 75Ω WE Center pin .090" A=2.457" B=1.225"..... PL2W</p>	 <p>Patch Plug Standard Crimp Plug with Locking Tab</p> <p>(WECO 440 Type) PL11SCLT- </p>
 <p>Termination Plug No chain</p> <p>50Ω RCA Center pin .070" A=2.81" B=1.58" TP-1-R 75Ω WE Center pin .090" A=2.45" B=1.25" TPW-1-R</p> <p>For other chain options, see page 63. (WECO 340C type)</p>	 <p>Patch Plug Solder Contact, Crimp Shield</p> <p>(WECO 440 Type) PL11C- </p>
 <p>Adapters Patch Plug to BNC/TNC</p> <p>50Ω RCA plug Center pin .070" 50Ω BNC A = 2.774"..... AD1 50Ω RCA plug Center pin .070" 50Ω TNC A = 2.774"..... ADH1 75Ω WE Center pin .090" 75Ω BNC A = 2.83"..... AD1W 75Ω WE Center pin .090" 75Ω BNC A = 1.93"..... AD1WHD 75Ω WE Center pin .090" 75Ω TNC A = 2.83"..... ADH1W</p> <p>(WECO 358 type).....</p>	 <p>Adapter 75Ω Miniature Patch Plug (Mini-WECO type) to 75Ω BNC</p> <p>ADMW12 </p>

 Refers to the Cable Group Table, see pages 78-120. **R** = Resistance

PATCHING PRODUCTS

75Ω MINI-WECO CoAX PATCH JACKS

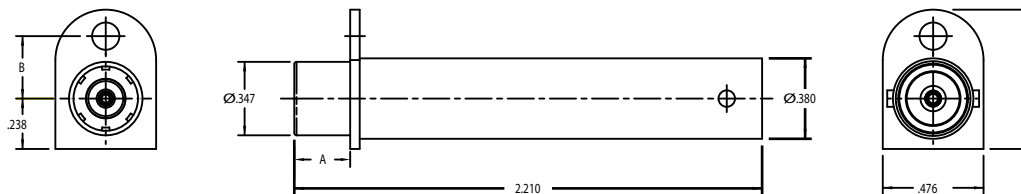

Miniature Patch Jack
Mini-WECO Type
BNC Rear Interface

J11MW

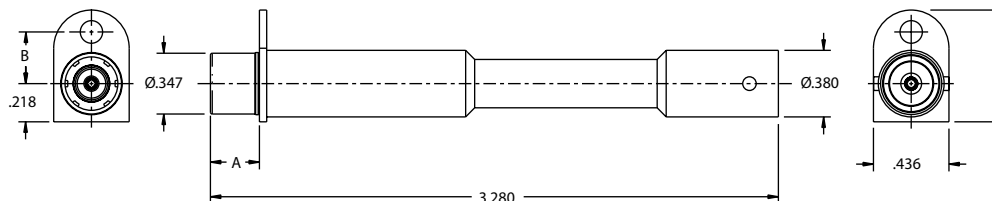

Miniature Patch Jack
Mini-WECO Type
BNC Rear Interface

J11MWL

PL1MWLT-(DASH NO)

DASH NO	CABLE ACCOMMODATED	A HEX
-009	8218, BELDEN	.178
	21-597, ESSEX	
	YR23023, BELDEN	
-013A	TCC-75-2, TROMPETER	.255
	8241F, BELDEN	
-014	8212, BELDEN	.255
-025	734A TYPE	.255
-026	735A TYPE	.178
-027	KS19224L2 LUCENT	.178

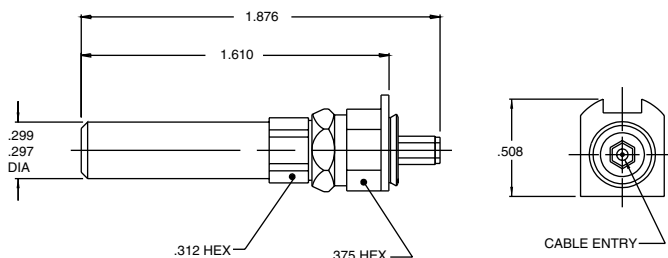

Patch Plug
Mini-WECO Crimp Plug
with Locking Tab

PL1MWLT

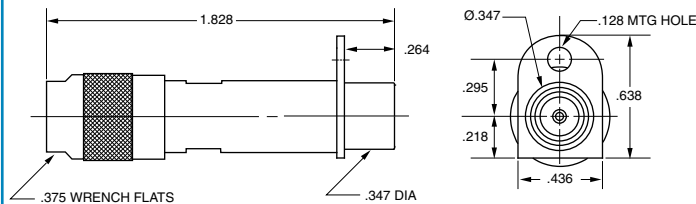

Miniature Patch Jack
Cable entry, field serviceable Mini-WECO type
centers

Minimum .64"
J12

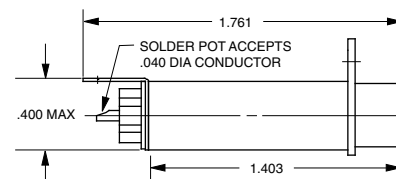

Miniature Patch Jack
Solder Pot, Mini-WECO type

J11D

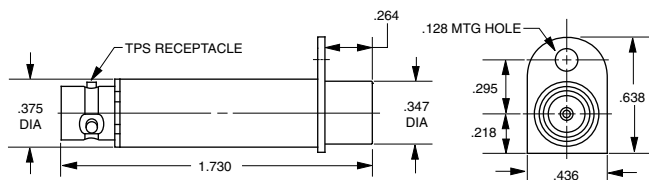

Miniature Patch Jack
TPS, Mini WECO type

J11

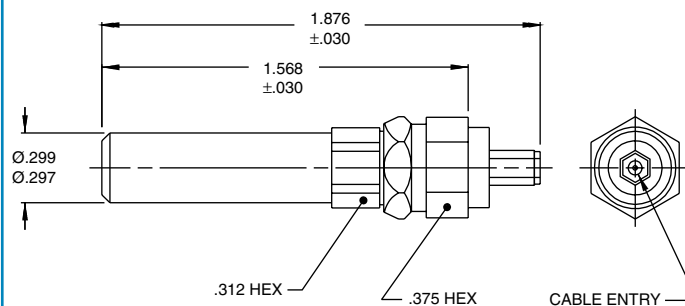

Patch Plug
Mini-WECO BNC Strip dimension
Crimp Contact, Crimp Shield

PL1MW

Refers to the Cable Group Table, see pages 78-120.