

1023 SERIES 1.0/2.3 DIN CONNECTORS - 75 Ω

Trompeter's DIN connector series, is manufactured to the DIN 47297 (75 Ω) interface specification. This range of Trompeter's DIN 1.0/2.3 connector are 45% smaller than the DIN 1.6/5.6 and is ideal for higher density patching requirements. With this space savings, significantly more ports can be placed in the same 1RU panels. The Trompeter 1.0/2.3 series includes cable plugs, cable jack and Type N to DIN adapters.

Trompeter's 1.0/2.3 series works with all of the most popular cables used in the video distribution and telecom central office environments and can rapidly be adapted to suit any coaxial cable developments.

This line of 1.0/2.3 connectors delivers the same superior quality performance of the industry leading Trompeter 220 Series BNC range. Employing the same tooling and termination as the 220 series BNCs ensures a minimal deployment cost and disruption for our customers.



Dimensions are in mm

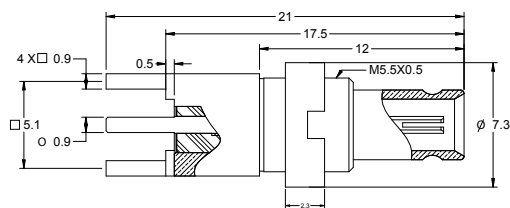

**Straight PC
Bulkhead Mount Jack**

UCBBJ1023

Dimensions are in mm

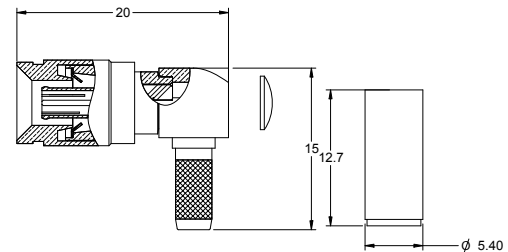

Right Angle Crimp Plug

UPLR1023-△

Dimensions are in mm

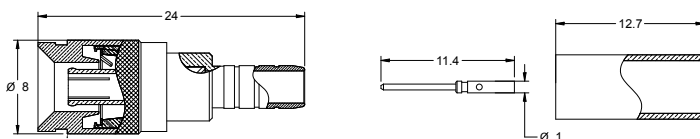

Straight Crimp Plug

UPL1023-△

Dimensions are in mm

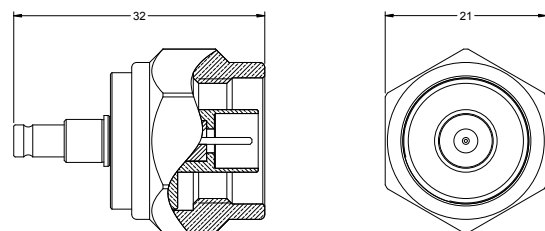

**Adapter 75 ohm Type N Plug
to DIN1.0/2.3 Jack**

UADF1023M95

Dimensions are in mm

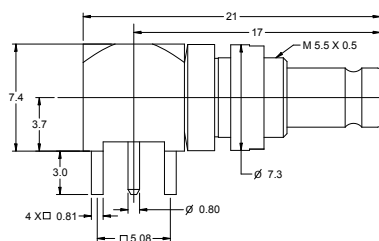

**DIN 1.0/2.3 Right Angle PCB
Bulkhead Mount Jack**

UCBBJR1023

Dimensions are in mm

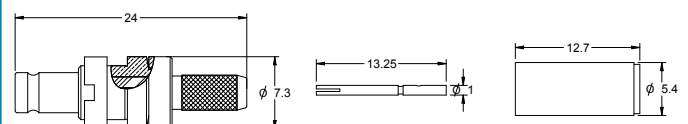

DIN 1.0/2.3 Bulkhead Jack

UBJ1023-△

△ Refers to Cable Group Table, see pages 78-120.