

COAX CONNECTORS

PUSH-ON COAX 120 SERIES

These BNC/TNC push-on jacks and plugs are designed for (U)PL123 blind mate rack and panel applications. The male plugs mate (U)PL122 with any BNC/TNC jack and are ideally suited for test/cable applications.

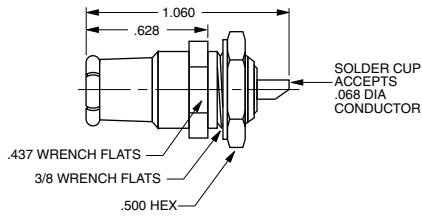

| | | |
|-------------------------|-----|-----------------|
| Panel Plug | 50Ω | PL121 |
| Front Mount, Solder Pot | 75Ω | UPL121 |
| w/ solder lug | 50Ω | PL121SL |
| | 75Ω | UPL121SL |
| Mounting Hole: C2.093 | | |

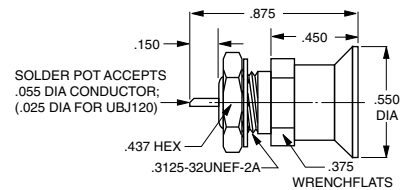

| | | |
|-------------------------|-----|-----------------|
| Bulkhead Jack | 50Ω | BJ120 |
| Front Mount, Solder Lug | 75Ω | UBJ120 |
| w/ solder Lug | 50Ω | BJ120SL |
| | 75Ω | UBJ120SL |
| Mounting Hole: C1.120 | | |

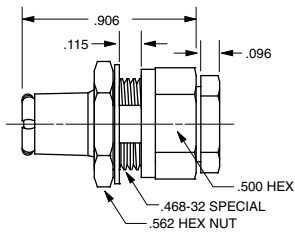

| | | |
|-------------------------|-----|---|
| Panel Plug | 50Ω | PL122- |
| Rear Mount, Cable Entry | 75Ω | UPL122- |
| Mounting Hole: DD5.187 | | |

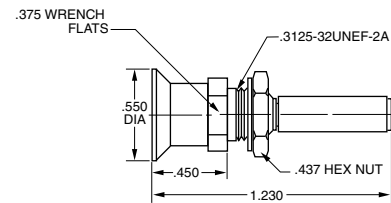

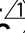
| | | |
|----------------------------|-----|--|
| Bulkhead Cable Jack | 50Ω | BJ120C- |
| Front Mount, Tool Crimp | 75Ω | UBJ120C- |
| Limited Cable Groups | | |
| Mounting Hole: C1.120 | | |

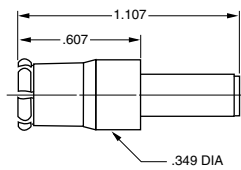

| | | |
|-------------------|-----|---|
| Cable Plug | 50Ω | PL223- |
| Tool Crimp | 75Ω | UPL223- |

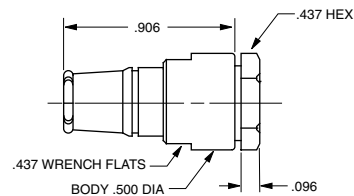

| | | |
|-------------------|-----|---|
| Cable Plug | 50Ω | PL123- |
| Wrench Crimp | 75Ω | UPL123- |

 Refers to Cable Group Table, see pages 78-120. "D" mounting holes are on page 60.