



Push Pull locking



All metal housing

neutriCON - Versatile Circular Connectors



ORP8F-Ni



OSC8F



ORP8M

- Complete set or modular system for any desirable configuration
- Contact configuration can be selected from 1 to 8 contacts
- Special crimp type strain relief establishes an ideal circumferential connection of the cable shield to the connector shell as required by best EMC working practice
- Precise and robust all metal housing absorbs vibration forces and protects contact inserts
- Easy, fast and screwless assembly
- Push-pull self-locking system

OSC8F / OSC8M

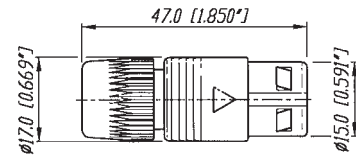

MODULAR SYSTEM

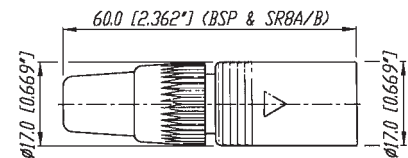

MC8 + SR8A/B + insert

ORP8F / ORP8M

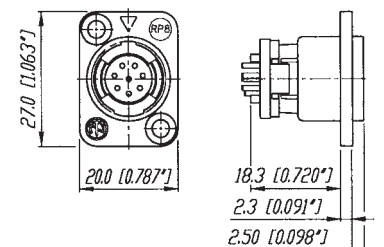

Polarization

Housing: Two variants of metal polarizing guides (90° and 180°).

Coding 90°

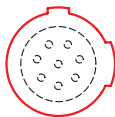

Coding 180°

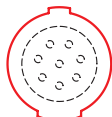

Insert: The male and female insert can be assembled in all three housings.

Ordering Information for complete neutriCON set

Complete set (consisting of housing, insert, 8 contacts and chuck for cable connector)

OSC8F	Female cable connector, chuck principle, black housing, solder contacts
OSC8F-Ni	Female cable connector, chuck principle, nickel housing, solder contacts
OSC8M	Male cable connector, chuck principle, black housing, solder contacts
OSC8M-Ni	Male cable connector, chuck principle, nickel housing, solder contacts
ORP8F	Female panel mount receptacle, black housing, solder contacts
ORP8F-Ni	Female panel mount receptacle, nickel housing, solder contacts
ORP8M	Male panel mount receptacle, black housing, solder contacts
ORP8M-Ni	Male panel mount receptacle, nickel housing, solder contacts

Ordering Information for modular neutriCON system

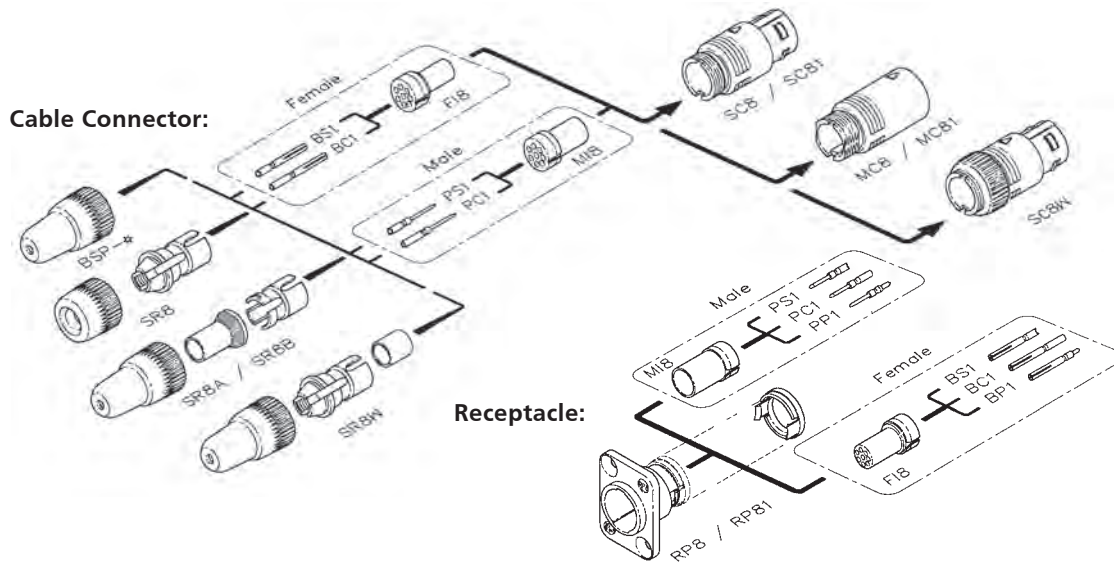

Modular system

Female

F18	Insert for cable connector and receptacle
BS1	Solder contact
BC1	Crimp contact
BP1	PCB contact
SC8	Cable housing, black coated, 180° coding
SC8-Ni	Cable housing, nickel coated, 180° coding
SC81	Cable housing, black coated, 90° coding
SC81-Ni	Cable housing, nickel coated, 90° coding
SC8W	Cable housing, black coated, 180° coding, waterproof multipin connector according IP54
RP8	Receptacle, black coated, 180° coding
RP8-Ni	Receptacle, nickel coated, 180° coding
RP81	Receptacle, black coated, 90° coding
RP81-Ni	Receptacle, nickel coated, 90° coding
SR8	Bushing and chuck type strain relief (standard)
SR8A	Crimp type strain relief for cable O.D. 3 - 3.8 mm (Hex crimp 5.41 mm acc. IEC 803, see also page 122)
SR8B	Crimp type strain relief for cable O.D. 6 - 7 mm (Hex crimp 7.01 mm acc. IEC 803, see also page 122)
SR8W	Bushing and chuck type strain relief for waterproof solution IP54
BSP-*	Coloured boot, available in 10 resistor colours

Male

M18	Insert for cable connector and receptacle
PS1	Solder contact
PC1	Crimp contact
PP1	PCB contact
MC8	Mating cable housing, black coated, 180° coding
MC8-Ni	Mating cable housing, nickel coated, 180° coding
MC81	Mating cable housing, black coated, 90° coding
MC81-Ni	Mating cable housing, nickel coated, 90° coding

* color coding: 0 - Black, 1 - Brown, 2 - Red, 3 - Orange, 4 - Yellow, 5 - Green, 6 - Blue, 7 - Violet, 8 - Grey, 9 - White

